

## GENERAL INFORMATION

### Product Support

### Cleaning and Care

modifications made by user or third party.



---

# LEGO

---

**Please read the installation manual carefully before commencement of installation.**

**Before carrying out any installation, please ensure that all power is switched off and disconnected from the main power supply.**

**This product must be installed by a qualified installer under local regulations.**

**The light source of the luminaire is not replaceable.  
When the light source reaches its end of life, the whole luminaire shall be replaced.**

1

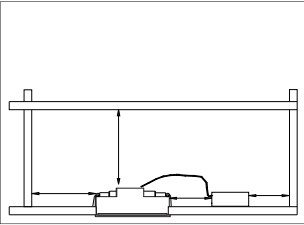

2

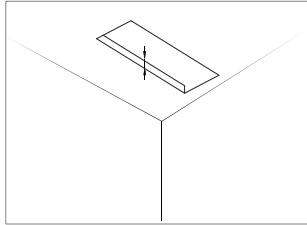

3

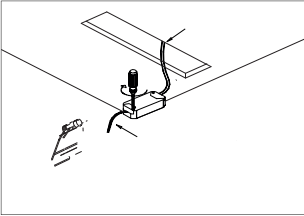

4

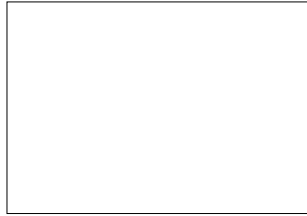

5

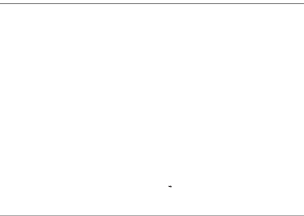

## INSTALLATION INSTRUCTIONS

### LEGO

1. Before installation or servicing, turn off and disconnect from main power supply. Ensure that there is 50-100mm clearance for LED driver and luminaire after installation.

2. Fixed luminaire can accommodate a ceiling thickness of 3-15mm. Cut out a rectangle hole according to the fixture cut out.

3. Connect main incoming supply to LED drive and luminaire to LED driver. Place the LED drive into the false ceiling; Avoid placing the LED driver close to a heat source.

4. Insert the LED luminaire into the hole by engaging the torsion spring clips upward away from the trim. Ensure the torsion spring clips are fully engaged in the ceiling and the luminaire is fully flush with the ceiling.

5. Luminaire and LED driver are not suitable for covering with the thermally insulating material. Restore power.